



SmartX6

Operator's Manual

Table of Contents

Safety Information	3
Overview of the phone	6
Quick Setup Guide	7
Phonebook/Calls	10
Messages	19
Chrome Web Browser	23
Apps or applications downloading/deleting/moving	25
Camera	27
Main Menu	28
Settings	31
Troubleshooting and support.....	38

Google™, Android, Google Play and other marks are trademarks of Google LLC

Safety Information

Read this entire manual carefully before you start using the device. This will take you a few minutes, but it will save you time later and will allow you to enjoy all the features on your device.

THIS MODEL MEETS INTERNATIONAL GUIDELINES FOR EXPOSURE TO RADIO WAVES

Your mobile device is a radio transmitter and receiver. It is designed not to exceed the limits for exposure to radio waves recommended by international guidelines. These guidelines were developed by the independent scientific organization ICNIRP and include safety margins designed to assure the protection of all persons, regardless of age and health.

The World Health Organization has stated that present scientific information does not indicate the need for any special precautions for the use of mobile devices. They note that if you want to reduce your exposure then you can do so by limiting the length of calls or using a 'hands-free' device to keep the mobile phone away from the head and body.

Additional Information can be found on the website of the World Health Organization.

How to handle and preserve your device

Trying to modify, disassemble or repair the device or the charger yourself will make the warranty invalid.

Avoid hitting or shaking your phone.

The warranty of this phone may be annulled if you use unauthorised accessories. To prevent this from happening and to keep your phone working properly use only the battery charger and Micro USB cable that originally comes with the device.

Make sure the device does not get wet. To avoid possible, short-circuit, electric shock or corrosion keep your phone away from rain, water splash, sweat or moisture. You must not use your device with your hands wet or immerse it in water. In case it gets wet keep the phone OFF and do not try to use a microwave to dry it.

This product should not be used in extremely hot, cold, dusty or humid spaces. Also the phone should not be exposed to long periods of sunshine or strong magnetic fields.

Avoid all heat sources, ovens or other appliances (including amplifiers) that produce heat or have hot surfaces.

Excessive high-volume levels or noise may affect your hearing. To prevent this from happening use an adequate volume in your earphones when you are listening to music or enjoying any of the multimedia features of the phone.

You are fully responsible for keeping your information backed up and we don't take any legal responsibility for data that is damaged or lost. It is possible to erase or interfere with the information stored in your phone by a magnetic device when using your phone. To avoid this from happening, keep your phone clear from magnetic devices.

Pointing the torch into your own or another person's eyes will cause damage and may result in blindness.

Safety recommendations while using your device

AIRCRAFT

Switch off your wireless device whenever you are instructed to do so by airport or airline staff. If your device offers a 'flight mode' or similar feature consult airline staff as to its use in flight.

DRIVING

Full attention should always be given to driving and local laws and regulations restricting the use of wireless devices while driving must be observed.

HOSPITALS

Mobile phones should be switched off wherever you are requested to do so in hospitals, clinics or health care facilities. These requests are designed to prevent possible interference with sensitive medical equipment.

PETROL STATIONS

Obey all posted signs with respect to the use of wireless devices or other radio equipment in locations with flammable material and chemicals. Switch off your wireless device whenever you are instructed to do so by authorized staff.

INTERFERENCE

Care must be taken when using the phone near personal medical devices, such as pacemakers and hearing aids.

For Pacemakers

Pacemaker manufacturers recommend that a minimum separation of 15cm be maintained between a mobile phone and a pacemaker to avoid potential interference with the pacemaker. To achieve this, use the phone on the opposite ear to your pacemaker and do not carry it in a breast pocket.

For Hearing Aids

Some digital wireless phones may interfere with some hearing aids. In the event of such interference, you may want to consult your hearing aid manufacturer to discuss alternatives.

For other Medical Devices: Please consult your physician/doctor and the device manufacturer to determine if operation of your phone may interfere with the operation of your medical device.

Safety recommendations for accessories

Use only Opel Mobile accessories or chargers that came with this phone

The lithium-ion battery can be put into use immediately after being unpacked. Use only the Opel Mobile battery that came with the device. We recommend charging the battery as soon as possible once the phone has been switched on.

Immediately stop using the battery charger if you smell an odour or overheats or a crack appears in the casing.

In case you notice the cable, or the plug have suffered any damage, discontinue using it and contact sales support line as soon as possible for advice.

The memory card should be protected from strong shocks and static electricity. Handle with care.

Usage conditions and restrictions

All packaging materials, especially plastic ones, must be disposed of properly. The lack of this procedure may cause a suffocation danger to children. Any packaging must be kept out of children's reach.

This device is not a toy and not designed for children and strict adult supervision must always be adhered to. Keep the phone and accessories beyond children's reach.

This device can be recycled. To dispose of this device properly remember to follow local regulations. Local authorities may guide you on finding appropriate facilities to this end. The battery must never be disposed of in a fire.

If this phone is lost or has been stolen please notify your network service provider as soon as possible and ask for the SIM card to be deactivated

You are fully responsible for any damage caused by not following these instructions or for improper use of the device. We do not accept any liability for any improper use or mishandling on this device.

Overview of the phone



Quick Setup Guide

Installing the SIM Card

This phone requires a Nano size SIM card, it is the smallest of the 3 SIM card sizes available. If you don't have a nano size SIM card contact your SIM card provider, they will be able to supply one for you.

The phone is capable of having 2 Nano SIM cards inserted. They can both be used in the device at the same time on any 4G network.

1. Make sure the device is turned off.
2. Using the silver pin provided, insert it into the small round hole located on the left hand side of the device until the SIM card tray unlocks and comes out slightly. Then pull the SIM card tray out of the phone.
3. Place your SIM(s) into the SIM tray until they are in place.
4. Slide the SIM tray back into the phone until it locks back into place.

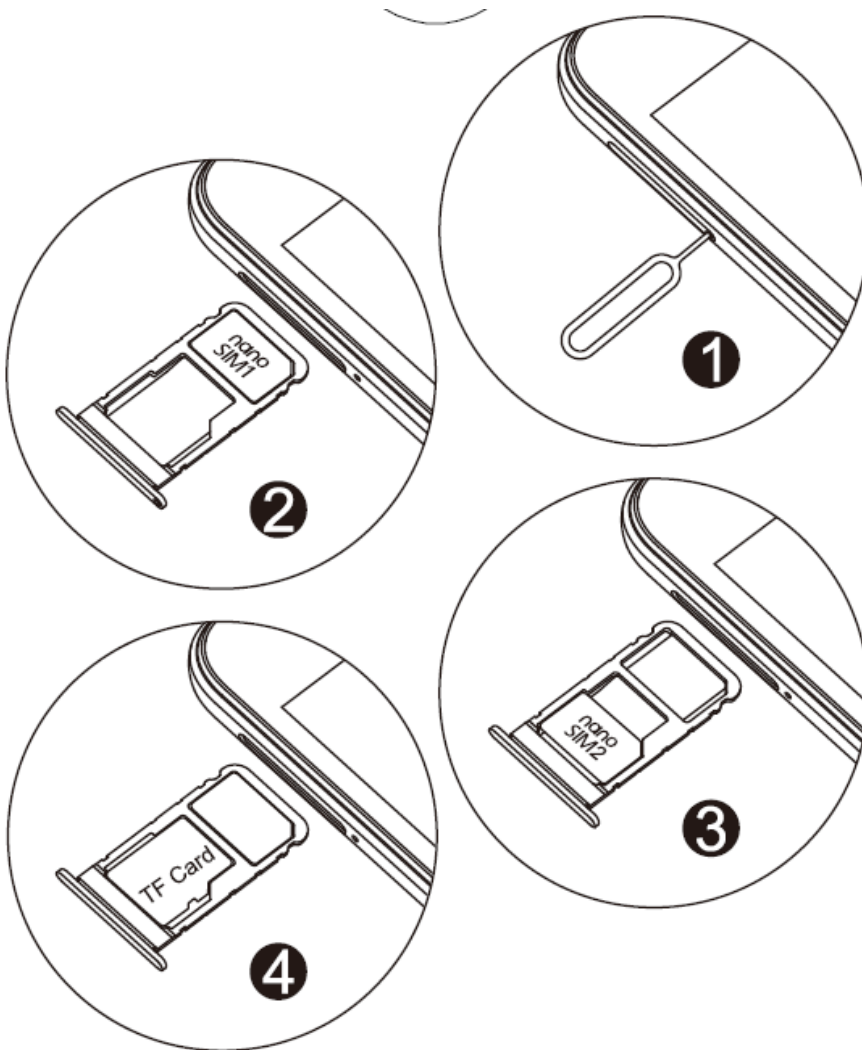

Installing (optional) Micro SD Card

The Micro SD Card or TF Card can be used as additional phone storage. You can store photos, videos, music, contacts and more.

1. Make sure the device is turned off.
2. Using the silver pin provided, insert it into the small round hole located on the left hand side of the device until the SIM card tray unlocks and comes out slightly. Then pull the SIM card tray out of the phone.
3. Place your SD Card or TF card into the TF Card slot.
4. Slide the SIM tray back into the phone until it locks back into place.
5. The phone will automatically recognise that a TF card has been inserted.

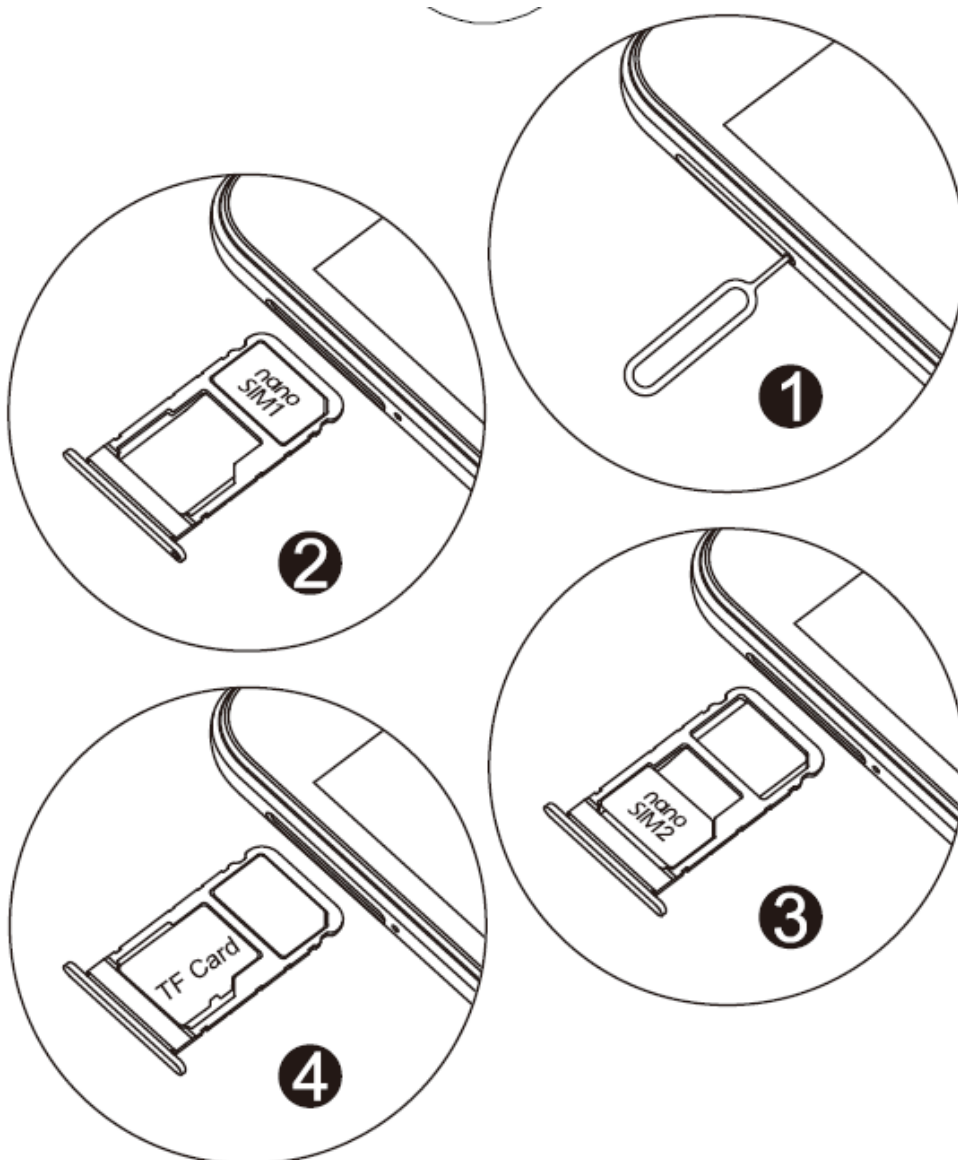

Charging the Phone

1. Connect the charger to the phone by inserting the Micro USB cable into the USB port in the phone and connecting the power adaptor to a wall socket and turn on

Please note: Ensure you charge the phone for at least 4 hours prior to use, to ensure long battery life.

Turning the phone on and off

1. To power the device on simply hold down the power key for 3 seconds.
2. To turn the phone off, simply hold the power button down for 3 seconds, it will then bring up the pop-up menu for you to select, Power off, Restart device or screenshot.

Turning the Phone on for the first time

After charging, turn the phone on by holding down the power button on the right side of the phone for 3 seconds

The phone will then ask for you to input the initial setup features.

1. Click Start
2. Connect to a Wi-Fi network (If no Wi-Fi available skip this step or use mobile network for setup)
3. Select copy data from previous phone or don't copy if you want to setup as a new device.
4. Sign in using your Google™ account or create a new account or skip this step
5. Unlock with fingerprint or skip this step. Fingerprint unlock is located on the back of the phone. Simply place your finger on the fingerprint unlock to setup your fingerprint.
6. Create a phone password using a pattern, PIN or password, or not now if you don't want to create a phone password
7. You can then add additional email accounts if needed or skip this step
8. To unlock your device when in standby mode. Simply click the power button once, then slide your finger up to unlock your device on the screen. If you have selected a password, then the phone will prompt you to enter the password to access the device, or if you have setup fingerprint unlock simply put your finger on the fingerprint unlock feature on the back of the device.

The Bluetooth® word mark and logos are registered trademarks owned by Bluetooth SIG, Inc. and any use of such marks by 3 Feet Solutions Pty Ltd is under license. Other trademarks and trade names are those of their respective owners

Phonebook/Calls

Adding new contacts

1. Tap on the phonebook icon

Tap on the phonebook icon



2. Tap on the contacts icon, then tap on "Create new contact"

Tap on "Create new contact"

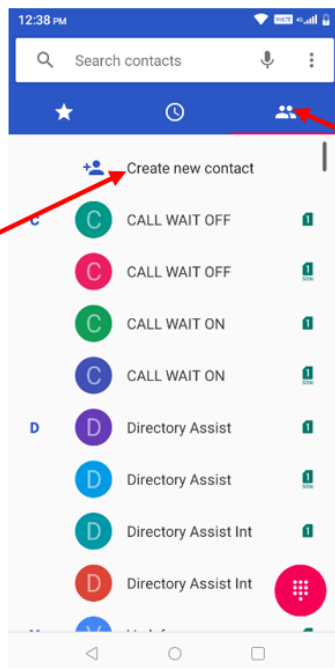

Tap on the contacts icon

3. Choose where you would like to save this contact (Phonebook, SIM card or email account)

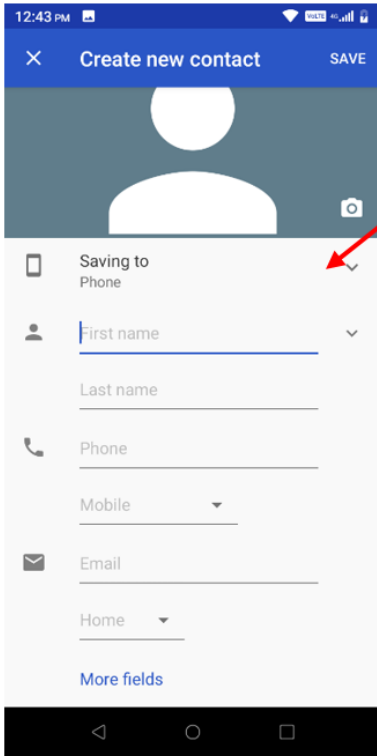

Choose where you would like to save your contact

4. Then fill in all the contacts details such as name, phone number, email, address and any other information you would like to save.

5. If you wish you can also take a photo or choose a photo to save to this contact, so when they call or you are searching for contacts this photo will appear. Click the camera icon on the top and choose to take a photo or choose an existing photo

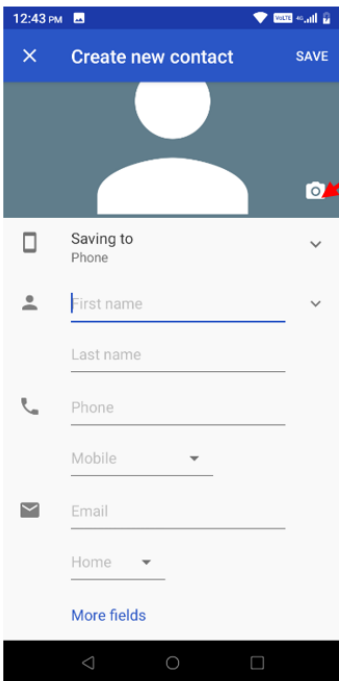

Tap the camera button and choose whether to take a photo or choose an existing

6. Click the save button when done.

Follow the same process to add all your other contacts

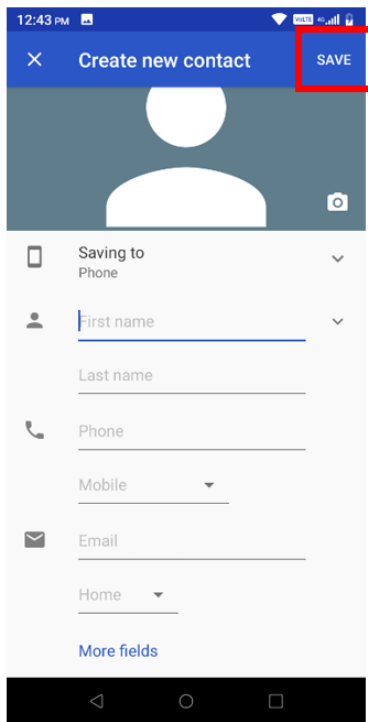

Phonebook Favorites/Recent call list

1. Click the phonebook icon



2. There are 3 tabs in the phonebook
Favourites, Recent call list and Contacts

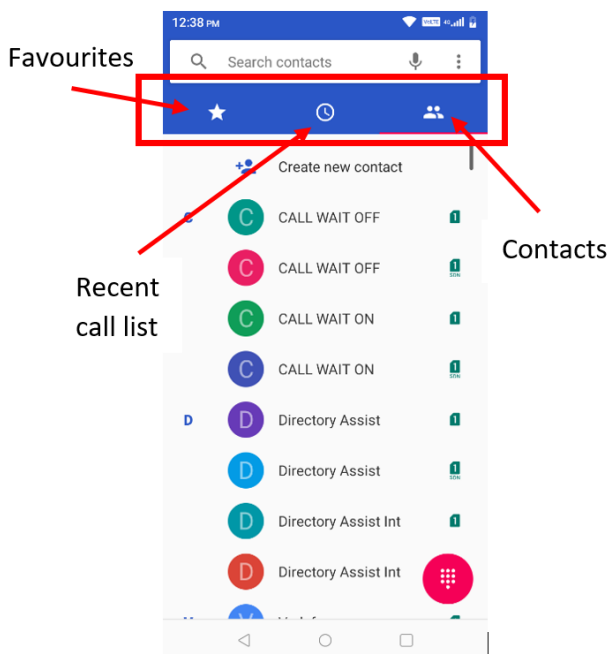

3. To add a favourite contact simply click add a favourite and select which contact you wish to add as a favourite. Once you have setup favourites you can call and message these contacts from this menu simply by clicking on that contact and selecting the call button or message button

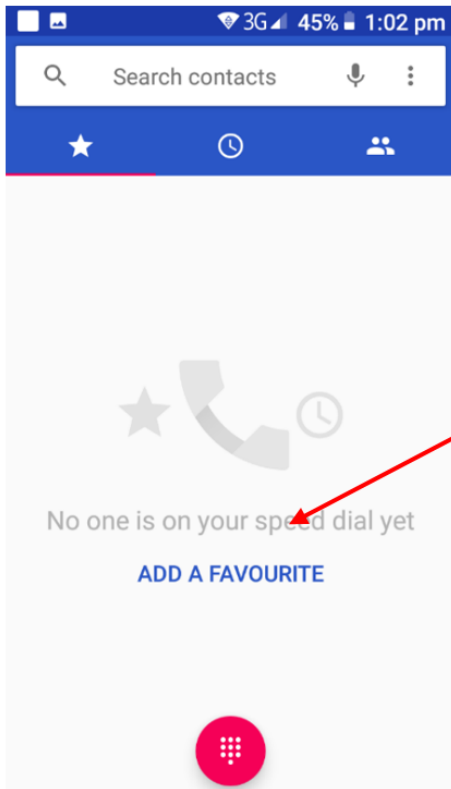

Tap here to add favourite's

4. Recent Call List will show all your recent calls you have made and received. You can click on any recent call to call this person again

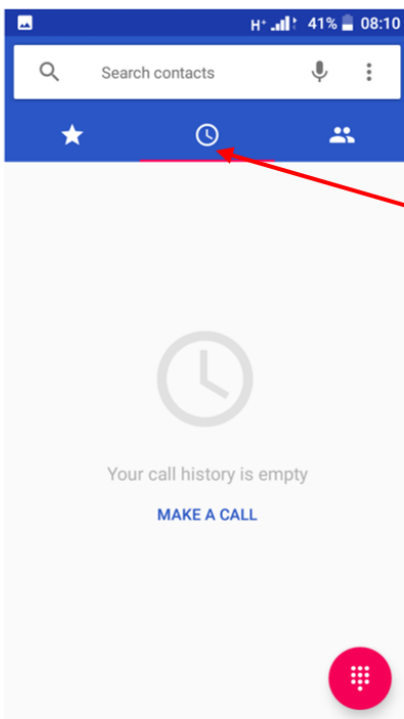

Tap here to see your recent call list

Search contacts

1. To search contacts simply tap on the Search contacts panel in the phonebook app.
2. Type in the contact name you are wanting to find using the keyboard.
3. Alternatively, you can also search contacts using the google voice search.
Tap on the microphone icon, then say the contacts name to search using google voice.

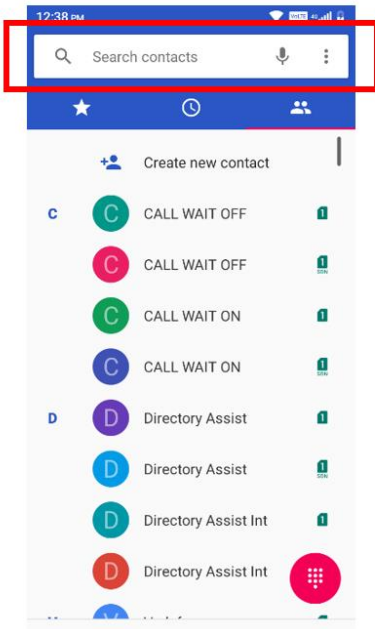

How to make a phone call

1. Contacts tab will show your entire contacts list. To make a call or message from this menu simply click on the person you wish to call or message and then click the call key or message key.

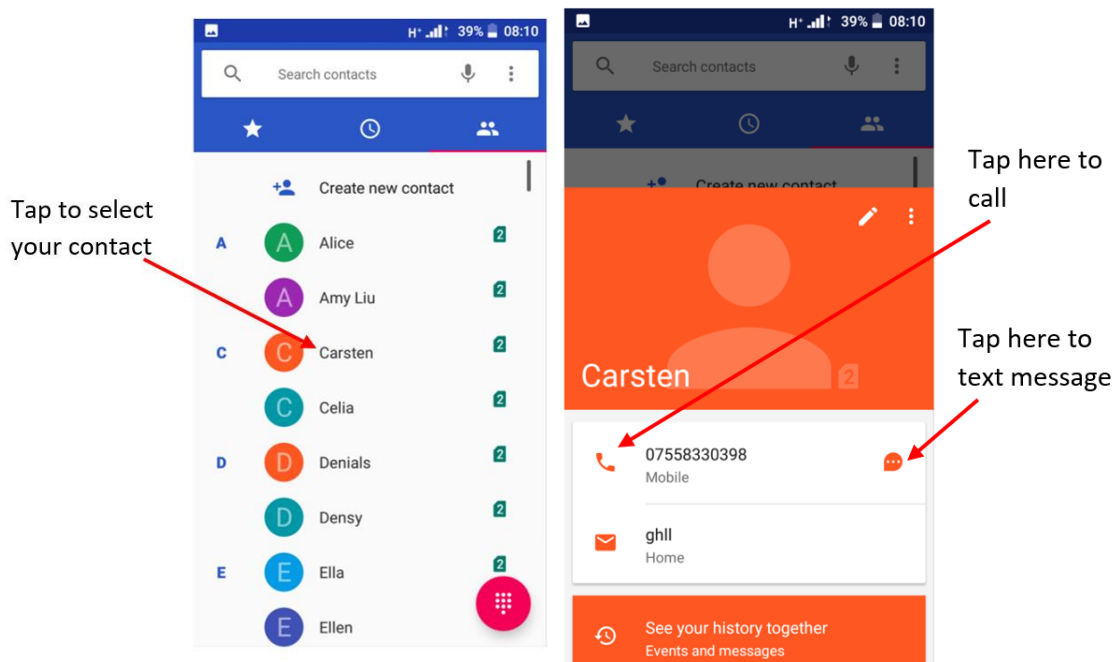

How to answer or reject a call

1. To answer an incoming call swipe up to answer the call or swipe down to reject the call

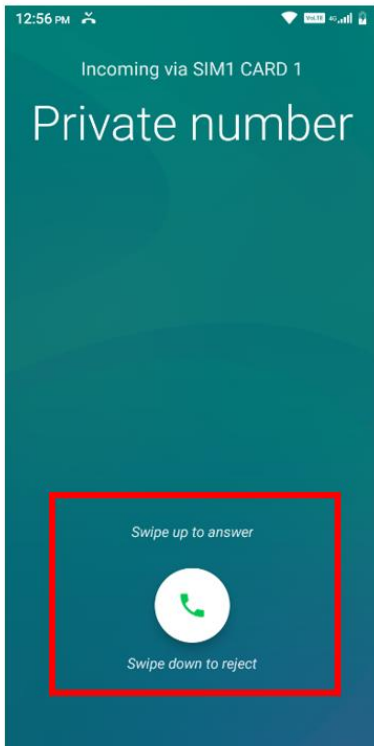

2. Once you have answered a call you have options to mute the call, put it on loudspeaker, add another caller or put the caller on hold. Tap any of these buttons to activate this feature. You can also bring up the keypad if you require to enter keys and numbers while on a call.

To end the call, click the red hang up button.

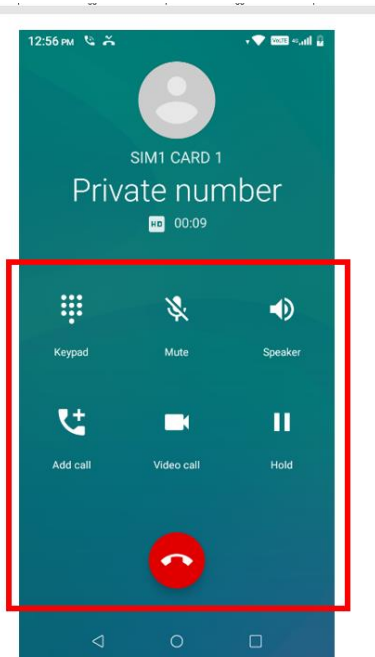

Phone Book Settings

1. To access Phonebook settings, tap on the settings icon while in the phonebook app, then tap settings.

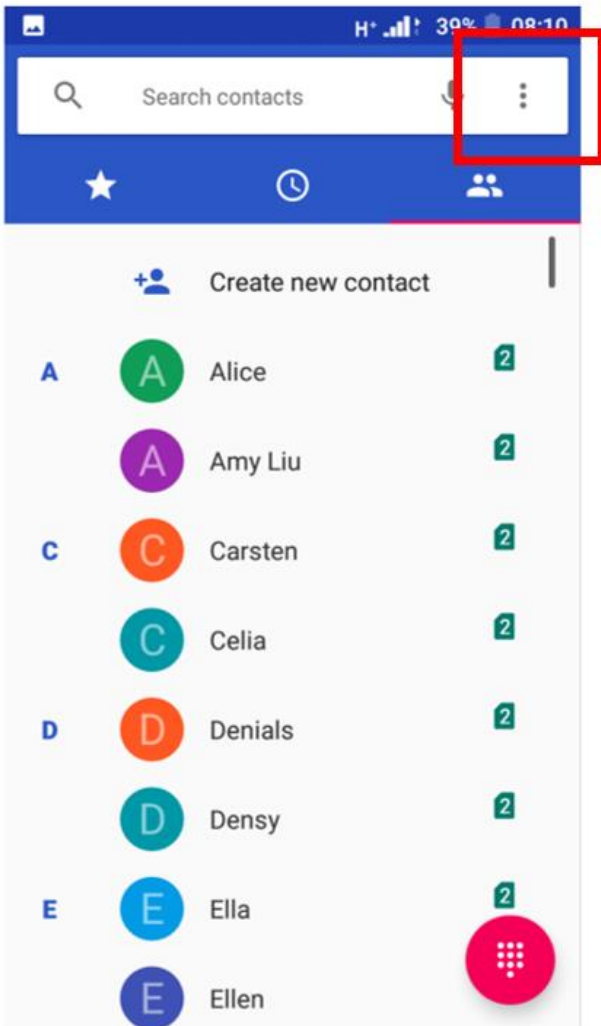

2. Within settings you can adjust your phonebook settings:

Display Options – You can sort by first name or last name and also change Name Format, First name first or surname first

Quick responses – Here you can edit quick responses

Calling accounts settings – Here you can adjust, Fixed dialling numbers, call forwarding, call barring, Wi-Fi calling and additional settings (Caller ID).

Voicemail – Voicemail settings and setup

Accessibility – TTY Settings

Fast Dial – Setup Speed dial

Prompts for call connection – Vibration for outgoing calls connect and Vibration for call disconnect

Flip to silence call – Flip the phone to silence incoming calls

Fade-in ringer – When enabled, incoming call ringer volume will be turned up

3. Call Blocking/Blocked numbers:

Within the settings icon you can tap on Block numbers.

You can create a blacklist of numbers then block these calls and/or messages by tapping on the settings icon in the call blocking menu.

4. Call history:

Tapping on the settings icon you can tap on call history.

It will show all your recent call history, missed calls, outgoing calls and incoming calls.

Messages

Write text messages

1. Click on the Messages icon



2. Click on the contact or type in the phone number you wish to send a text message to

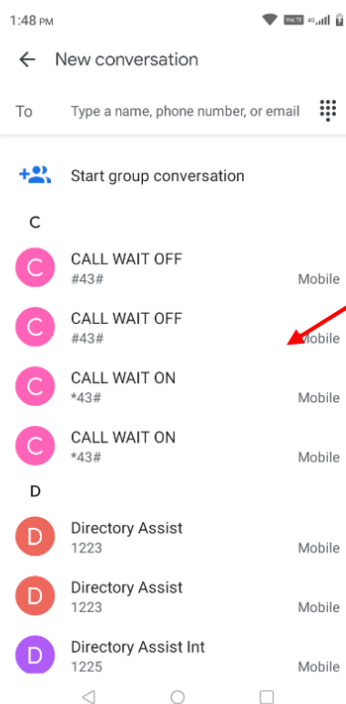

Tap on the contact you wish to send a message

3. Once you have selected the contact. Write the message you wish to send using the screens keypad, you can also send images and attachments using the plus key, then click the SMS button to send the message

Tap the plus sign to add images or attachments

Tap SMS button to send the message

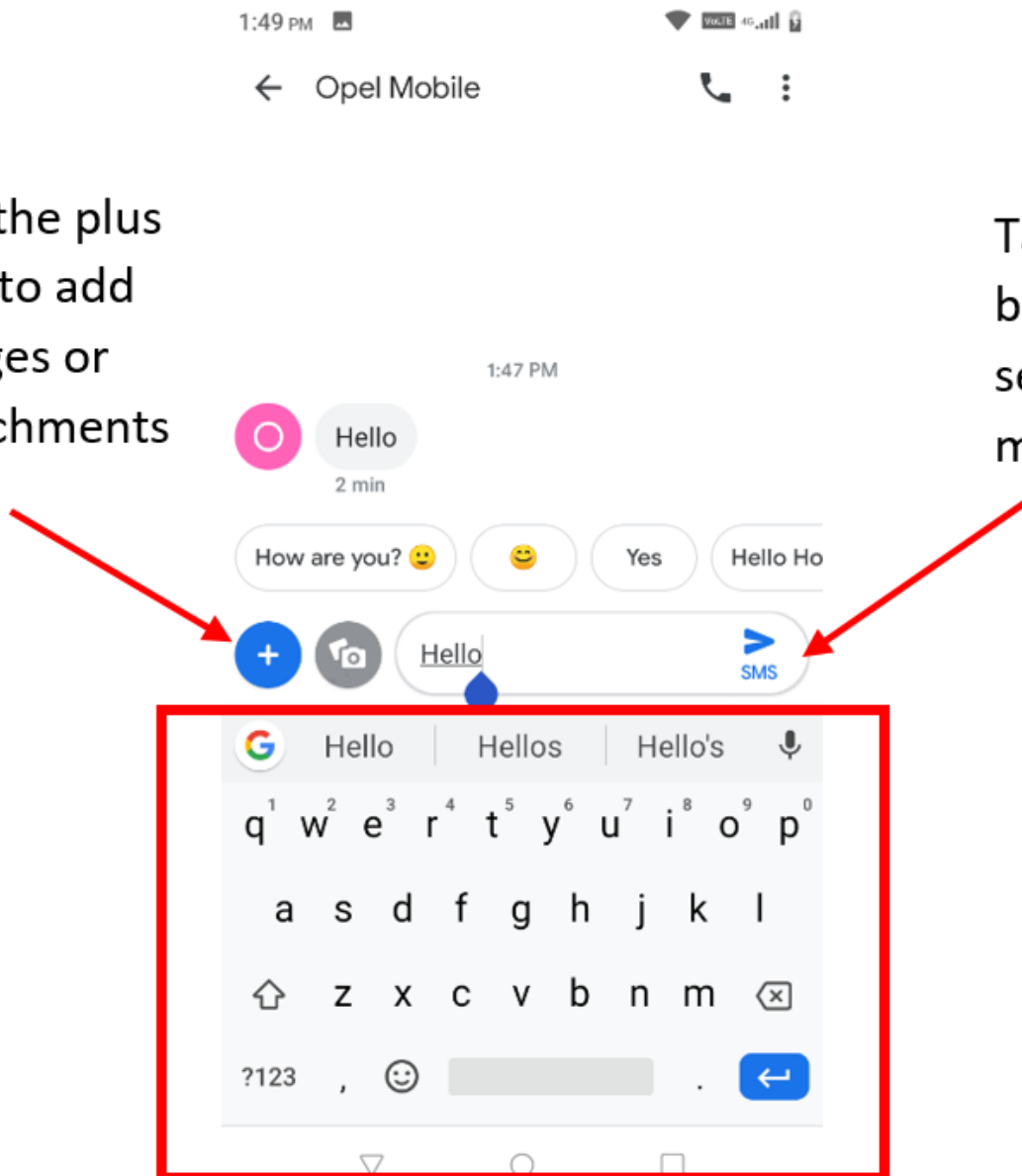

View messages

1. To view a message you have received click on the Message icon.

Any message that is bold is unread messages you have received. Click on that message to view. You are also able to reply to that message from the view screen



Tap on
the
message
you wish
to view

Message Settings

To access your message settings, click on the settings icon, then tap on settings within the message app.



Within message settings you can adjust the following:

Default SMS app – you can change which app to use as default for messages, you may have a preferred app you wish to use.

Notifications – You can adjust your notification settings, turn them on or off, change importance, sound, vibrate and do not disturb settings.

Hear outgoing message sounds – turn this on or off.

Suggestions in chat – Smart Reply on or off, suggested actions on or off.

Chrome Web Browser

To access the Chrome web browser, tap on the Chrome web browser Icon



1. You can search webpages using the Google search engine, or if you know the webpage address, type it in the search panel bar.
2. Using the touch screen you can scroll through webpages, click on links and more

Google Apps

To access the google apps folder, tap on the google folder.

Inside this folder, there is Google, YouTube, Gmail, Google Assistants and Maps. To open one of these apps simply tap on the application to launch it.

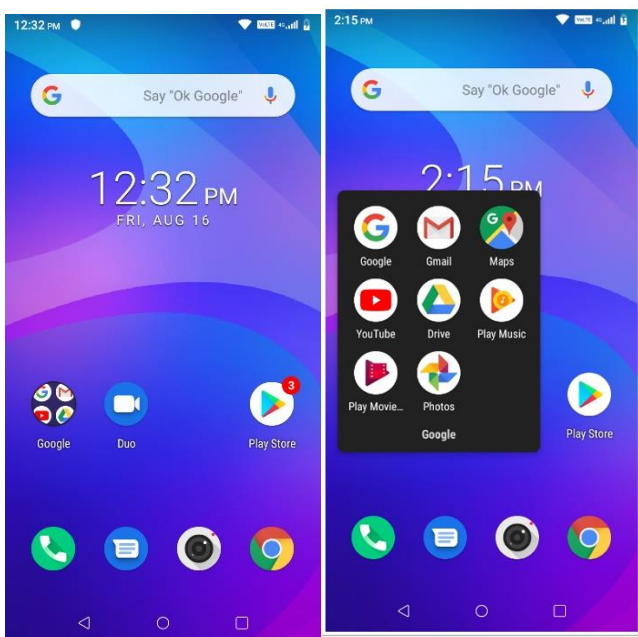

Google

This app is your quick search and application tool. You can search web pages/content and voice search.

YouTube

Search and view popular videos or videos you wish to watch. To search for a video, simply tap on the search icon and type in the name of the video you want to find and watch.

Gmail/Email

This is where you can access your email account/s.

To setup an email account:

1. Simply press add an email address
2. Choose which type of email account you have
3. Then follow the steps on that type of account to add the email to this application

Once setup you can access all your emails via this application. You will be able to view, edit, write and delete emails.

Maps

This app will help you find an address or place and give you the direction on how to get there from your current location. You can select whether you're driving, walking, riding on a bike or using public transportation.

By typing in the address or name of the location you wish to go, it will give you the fastest route to get there.

Drive

With this app you can save documents, photos, videos and more on the google drive cloud to save storage space on your device and to access these files on other google supported devices

Play Music

If you have any saved music on your device, you can play the music via this app.

Play Movies

With this app you can play movies and videos

Photos

Here you can access and store all your photos you have taken or stored on the device

Apps or applications downloading/deleting/moving

To download new applications to your phone like Facebook and WhatsApp, you must create a Google account.

When clicking on the Play Store, if you don't have a Google account you can create one here.

1. Click on the Google Play Store



2. Search and download the app you wish to download and click install.

Once installed the app will show on your home screen, by tapping on that app it will open for you to use.

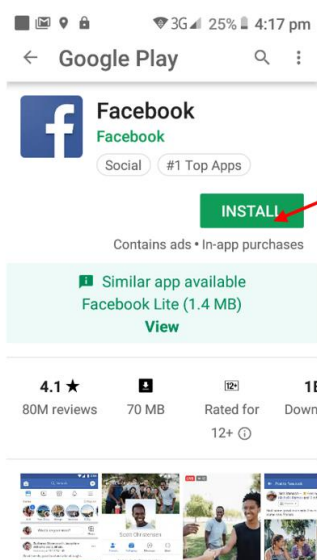

Tap on the install button to install that app on your phone

3. To remove or move an app simply hold your finger on the app for 3 seconds, continue holding your finger on that app, you can then move it around to a new location or move it to the top of the phone to delete the app.

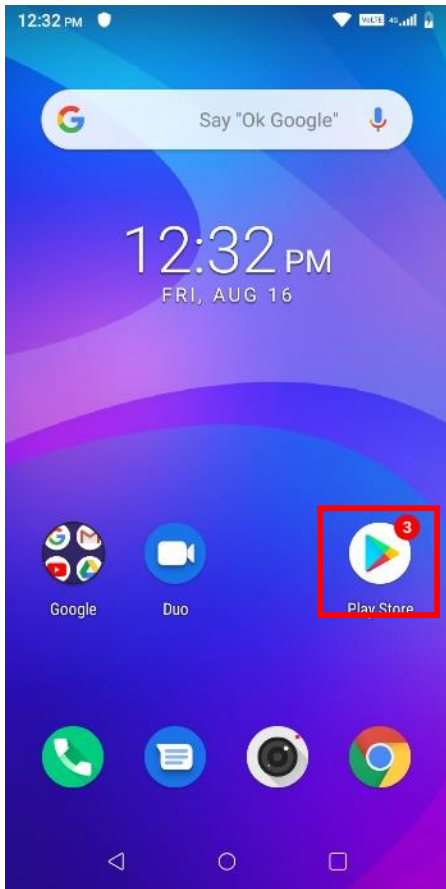

Tap and hold on the app you wish to move or delete. While holding your finger on the app, you can then move it to a different location on your phone or move it to the top of the phones screen to delete the app

Camera

The camera has many features. You can use the camera to take still shots or to take videos. It has 2 cameras, one placed on the back of the phone and also one placed at the front of the phone.

1. Click on the camera icon to activate camera mode



Camera functions

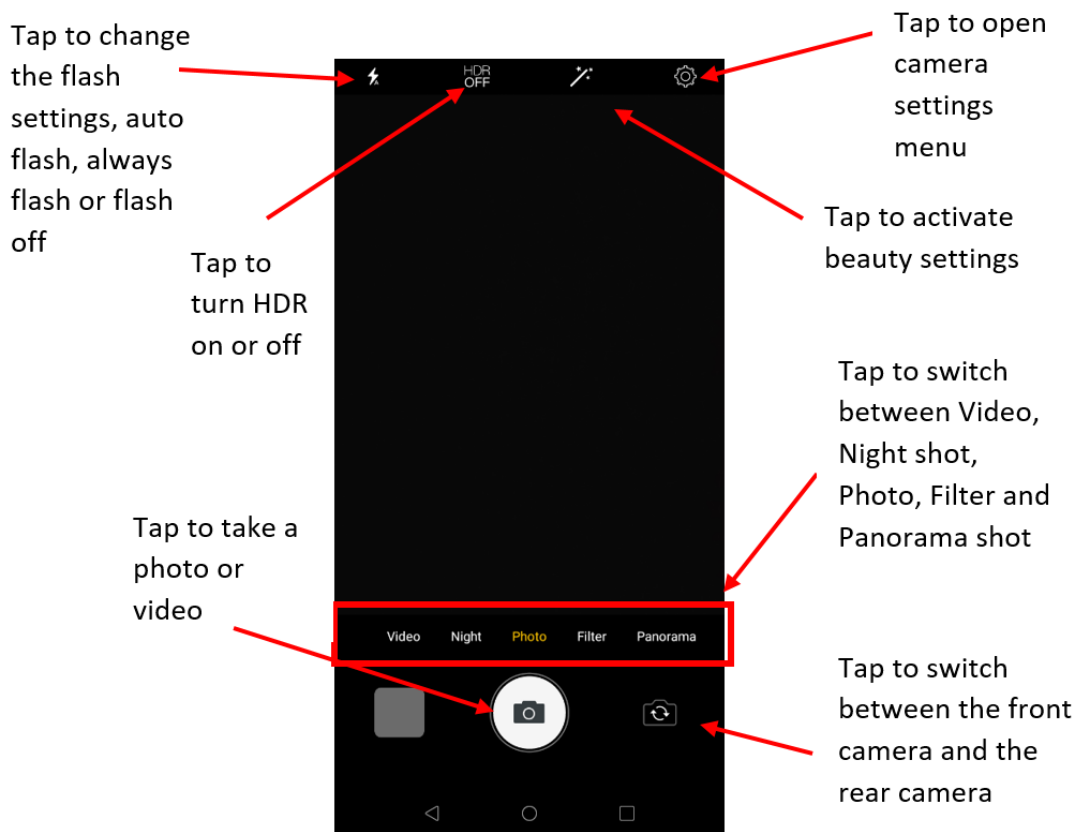

Main Menu

To access the main menu to view all your applications on this device, simply swipe up on the home screen to open the main menu.

You will find the following applications in the menu. Open the various applications by tapping on their respective icons.

Calculator

Just like a typical calculator you can calculate sums using this application. Simply tap on the screen to use the calculator and enter your numbers and symbols.

Calendar

This will launch your account/s calendar.

By scrolling up and down you can view all your events and meetings.

To add an event or meetings tap on the plus sign and follow the instructions to add in your event or meeting.

You can view your calendar by day, 3 day, week or month, to change this simply press on the Menu icon in the top left corner.

Call History

This app will show all your recent call history. All call history, missed calls, outgoing calls and incoming calls.

Camera

This will launch the camera app so you can take photos or videos.

Chrome

The app will launch the chrome web browser, so you can search for webpages to view

Clock/Alarm

Within this application you can set/view alarms, view world times, access timer and stopwatch. Simply press on one of those icons to access that application.

Contacts

This application will open all your saved contacts on your SIM card or phones storage. You are able to add new contacts, edit contacts, call contacts and message contacts via this app.

Drive

Here you can view, save and edit any stored files.

Duo

Duo is a google application which you can use for making calls and video calls.

Files

In this application you can view all your files that are on your device such as downloads, images, videos, audio, documents and apps.

FM Radio

To use the FM Radio, you must have headphones plugged into your device, as these will act as your antenna signal to pick up the radio channels.

Simply use the fast forward/rewind buttons to scroll through FM stations.

To save a station as a favourite tap on the favourite star to save this station.

Tapping on the menu icon on the screen will bring up all available stations, tap on one of the stations to listen.

To stop the FM Radio, simply press the stop icon on the screen or to continue listing press the play icon.

Gmail

This is the google Gmail application. You can use this application to send and receive emails.

Google

This will open the Google search and voice search engine. You can type and say any topic or task and it will reply with an answer or go to an application or webpage of your choice.

Keep Notes

In this application you can make notes and reminders for tasks you wish to do.

Maps

In Maps you can search and create routes to get you to different locations easily.

Messages

Within this app, you can create, send and view messages from your contacts.

Phone

This application allows you to add, view, call, message your contacts.

Photos

The photo app allows you to view, edit and share photos.

Play Movie

Within google play you can buy and save movies so you can watch them on the device.

Play Music

Here you will be able to access any music you have saved on your device. You can subscribe to Google Play and access 1000's of songs to listen to. Please note there may be subscriptions fees to access Google Play.

Play Store

Within the Play Store, you can search and download any application of your choice.

Screen Capture

Within the screen capture app, you can adjust the settings of this application. To take a screen capture of your device simply hold down the power button and then press screen shot.

Sound Recorder

Within sound recorder, you can record sounds. Simply press the red record icon to record a sound or voice.

YouTube

In the YouTube app you can watch, search and view videos of your choice.

Settings

To access your phones settings, swipe up on the touch screen whilst on the home screen. Then tap on the Settings app to open settings.

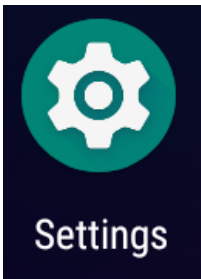

To access different settings simply tap on the setting you wish to edit or change.

Network and Internet

Wi-Fi

1. To turn on and access a Wi-Fi network click on Wi-Fi to turn it on.

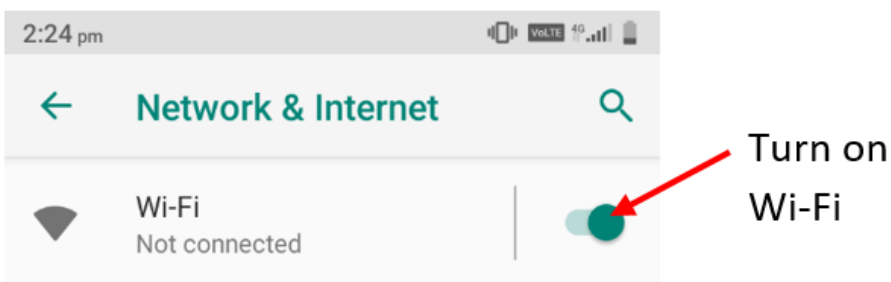

2. Then choose which network you would like to connect to and enter the password if applicable.

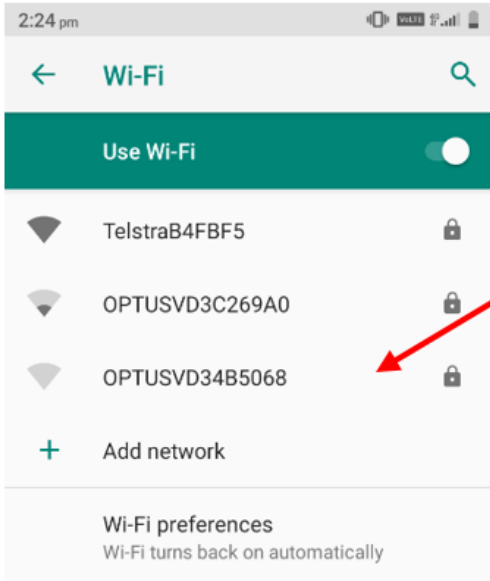

Choose which Wi-Fi you wish to connect to and enter password if applicable. Once connected it will say connected.

Mobile Network

Under the Mobile Network settings, you can edit mobile data access, roaming settings, view data usage and other network settings.

Hotspot and tethering

This setting will allow you to use your device as a Wi-Fi network and will use data on your SIM card account. You can connect another device to your phone via the Wi-Fi hotspot or connect using Bluetooth. Tap on the selection you wish to use to turn it on. Then on your other device search for this device to access the network.

Aeroplane mode

By tapping on aeroplane mode this will de-activate your phones ability to connect to your network. This is best used when entering an aircraft. You will still be able to access Wi-Fi connections and Bluetooth connections.

Connected devices

Within this menu you can view and access any devices that are connected via Bluetooth or USB.

1. To turn Bluetooth on; connection preferences, then Bluetooth, then turn on Bluetooth.

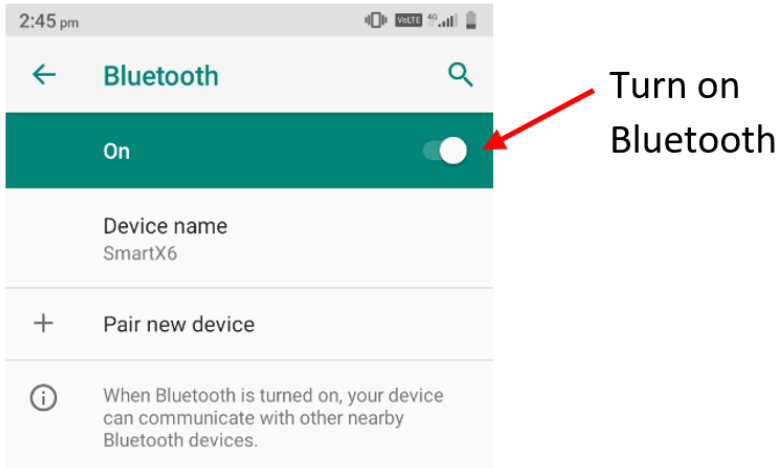

2. Click on Pair new device if you haven't connected to this device before. It will then search for available Bluetooth devices. Ensure your Bluetooth device that you're trying to connect to is turned on

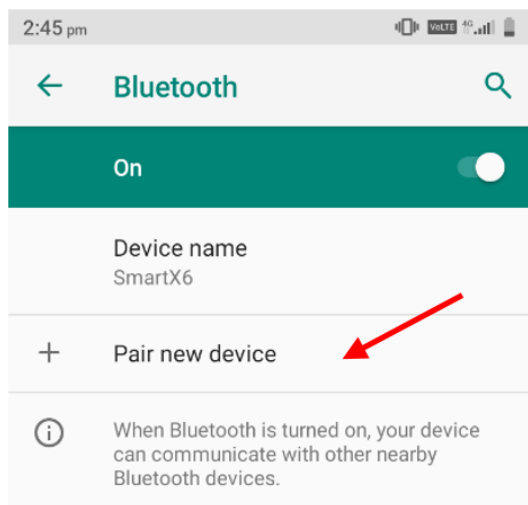

3. Once a new device has been found click on that device to pair. It may ask for a password which you will need to enter to connect on each device. Most default passwords are either 0000 or 1234.

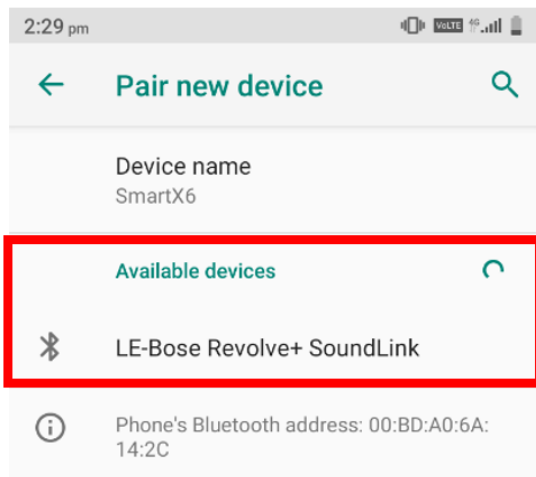

4. It will then say connected once they have paired. You can now transfer files, music or take phone calls on the paired device.

Apps and notifications

This Menu will show you recently opened apps, all apps on your device. You can click on an app to manage the usability of that app, disable it, force stop and any other setting for that app.

You can also manage your notification settings, App permissions, app defaults, Do not disturb preferences and any special app access.

Battery

Within this menu you can manage your battery settings. You can view your battery usage and adjust your power management settings.

Display

Inside the Display menu you can adjust your Brightness level, Wallpaper design, Sleep timer, Screen rotation settings, font size and screen saver design.

Scheduled power on/off

You can use this menu to schedule your device to power on and/or off. Simply tap on the function you wish to set, select the time and repeat options.

Navigation bar

In navigation bar, you can adjust the settings of the navigation bar located on the bottom of the screens device.

Sound

In the sounds folder you can adjust and change your media volume, call volume, ring volume, alarm volume, do not disturb settings, prevent ringing settings, phone ringtones, notification tones, alarm sounds and other sounds and vibration settings.

Storage

This menu will show you your current storage usage on your device

Security and location

Within security and location you can change your screen lock settings, lock screen preferences, Fingerprint lock settings, location settings, password view settings, SIM Card lock and screen pinning

Users and accounts

In this menu you can view and add user accounts and adjust sync data settings.

Accessibility

Accessibility is designed to help you use your device the way it is best for you. You can adjust volume key shortcuts, Select-to-speak settings, talkback settings, Text-to-speech output, Magnification settings, Mouse cursor settings, interaction control settings, audio and on-screen text settings.

System

Within System settings you can adjust and change, languages and input settings, Gestures, Date & Times settings, Backup settings, System updates, reset options and information about your device.

Shortcut Menu

To access the shortcut menu, swipe down on the screen while on home screen mode. Within shortcuts you will be able to access and adjust the following menus.

Wi-Fi

By tapping on the Wi-Fi icon you can turn on your Wi-Fi settings and connect to an available network

Bluetooth

Tapping on the Bluetooth icon you will be able to turn Bluetooth on or off and connect to available bluetooth devices.

Do not disturb

By tapping on Do not disturb, you will be able to turn this function on or off and adjust any settings for this function

Wi-Fi Calling

You can turn this function on or off. In this mode you can call using your Wi-Fi network.

4G SIM1 or 4G SIM2

4G Dual SIM selection

Torch

By tapping torch, this will turn the torch function on or off

Auto-rotate

Tapping Auto-rotate will turn this function on or off

Mobile data

This will allow you to quickly turn data settings on or off

Aeroplane mode

Tap aeroplane mode to turn this function on or off

Hotspot

You can turn this function on or off

Location

Tapping this function will allow you to quickly turn this function on or off.

Smart Saving Mode

You can turn this function on or off. By turning this function on it will help increase the battery life.

Troubleshooting and support

If you are experiencing difficulties with your mobile phone, please go through the following troubleshoots

The Mobile Phone will not power on:

1. Ensure you are pressing and holding the power button for 5 seconds.
2. Ensure you have charged the phone for at least 10 minutes

The phone is asking for a PUK code:

1. This means you have input the incorrect password 3 times or more. Contact your network provider to retrieve your PUK code to unlock your phone as only your network provider can help unlock your SIM

SIM card error or no SIM card:

1. Ensure you have inserted the SIM card correctly and are using the correct size SIM card. Follow instructions in the quick set up guide for installing the SIM Card
2. Your SIM card may be damaged or dirty, ensure you replace your SIM with your Telco provider if this error occurs.

Failure to connect to the network:

1. Your network signal may be weak or out of range. Contact your network provider or try the phone in a different location to check your signal
2. Your SIM card may be damaged, invalid or has no credit. Contact your network provider for support
3. Ensure your data is switched on

Failure to make an outgoing call:

1. Ensure you have entered the correct phone number you wish to dial.
2. Ensure you have enough credit on your provider's account. Contact your network provider for support
3. Your signal strength may be weak. Check your signal strength and contact your provider

Cannot hear anyone on the call:

1. Ensure your call volume is adjusted to your requirements. Using the volume keys on the right side of the phone

2. Ensure you have sufficient signal strength

Cannot receive calls:

1. Ensure your mobile phone is switched on
2. You have enough signal strength to receive calls
3. Ensure you do not have the phone in flight mode
4. Ensure your SIM card is installed correctly

The other party cannot hear you on the call:

1. Ensure your phone is not set on mute mode
2. Ensure the other party has their volume turned up to their desired level

Mobile Phone wont charge:

1. Ensure the power plug is inserted in the wall socket correctly and the wall switch is turned on
2. Ensure the wall power socket is working by testing another device or a separate power socket
3. Ensure you have inserted the micro USB cord into the phone correctly
4. Ensure there is no dirt or dust accumulated in the phones power socket
5. Ensure you have left the phone on charge for at least 10 minutes as the battery may have run out of charge completely

Mobile phone won't connect via Bluetooth:

1. Ensure you have turned on and activated the Bluetooth settings. See Bluetooth guide in manual.
2. Ensure the other device has Bluetooth enabled
3. Your Bluetooth device may be too far away from the other device to connect. Ensure you are within range of this device to connect
4. Ensure you follow the Bluetooth instructions above

Mobile phone won't connect to Wi-Fi:

1. Ensure you have turned on and activated Wi-Fi on your phone. See Wi-Fi guide in the manual.
2. Ensure the Wi-Fi you are connecting to is working.
3. Your device may be too far away from the Wi-Fi Router. Ensure you are within range of this device to connect